

NEW PRODUCTS

CATALOG 2025 / 2026

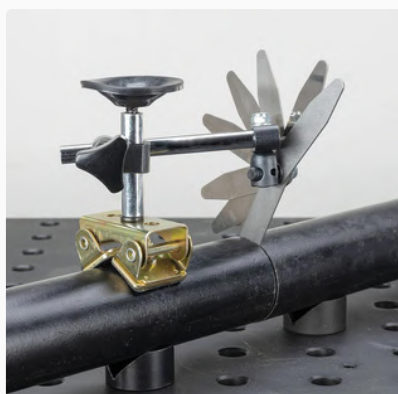
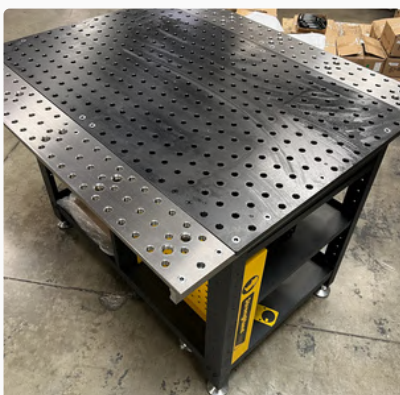
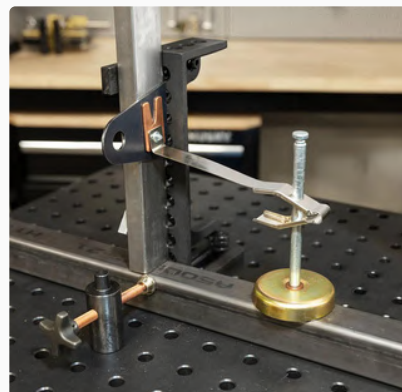

**BOLD NEW CONCEPTS TO HELP YOU WORK
COMFORTABLY & PRODUCTIVELY.**

**Strong
Hand
Europe**

www.stronghand.eu

NEW PRODUCTS 2025

RHINO CART & EXPANSION OPTIONS

NEW RHINO CART OPTIONS!

A set of innovative mobile welding and working stations designed to elevate your productivity to new heights.

Electric Rhino Scissor Lift

Electric powered scissor lift is a variation of our existing lift (TDSL12075) that uses 110V power to raise and lower instead of a foot pump.

- **Effortless and efficient:** Through electric drive, a lot of physical energy can be saved and work efficiency can be improved.
- **Easy to operate:** Equipped with a controller, the operation is simple and convenient. Control Pendant comes with magnets to easily keep it in reach, or store in the special holder.
- **Height adjustment:** By using Control Pendant, the height can be quickly adjusted and the lifting speed is stable.
- **Reduce labor intensity:** For work environments that require frequent lifting, electric lifting platforms can significantly reduce the workload of workers and help prevent occupational diseases.



Part No.	Tabletop Dimensions (mm)	Tabletop Thickness (mm)	Hole Diameter (mm)	Grid Pattern (mm)	Height Adjustment (mm)	Load Capacity (kg)	Weight (kg)
TDESL12075	1200 x 750	16	16	50 x 50	640 - 1040	500	250

NEW PRODUCTS 2025

RHINO CART & EXPANSION OPTIONS

Rhino Cart Mobile Working Station

Now available with expanded storage options. Discover the power of customization with our new frame based hole mounting pattern.

At Strong Hand Tools and BuildPro Tables, we value the feedback from our welding community. Your insights created the next generation of Rhino Cart: the F3.

Designed with enhanced features based on your needs, the F3 takes fabrication versatility and convenience to an entirely new level.



Enhanced Mounting Options

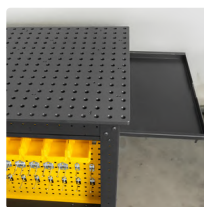

Versatile Slag Trays



Improved Electrical Access

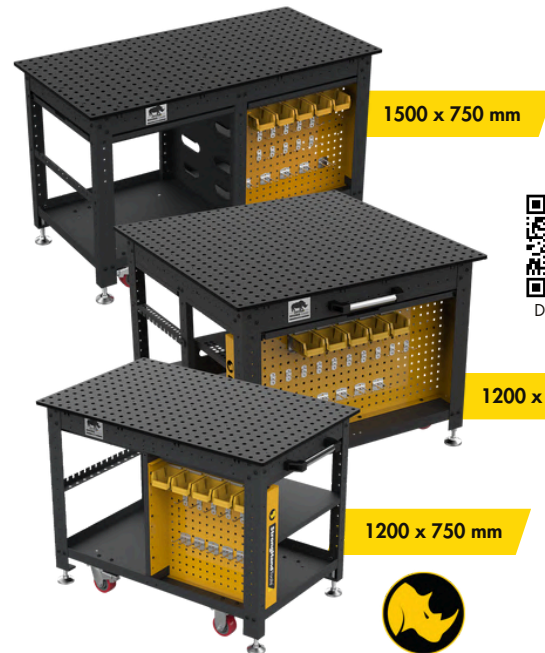

Demo Video



Part No.	Tabletop Size (mm)	Table Height (mm)	Tabletop Plate Thickness (mm)	Tabletop Flatness (mm)	Static Loading Capacity (kg)	Weight (kg)
TD6-1275Q-F3	1200 x 750	910	16	0.3 per 600 x 600	680	210
TD6-1212Q-F3	1200 x 1200	910	16	1.0 per 600 x 600	544	294
TD6-1575Q-F3	1500 x 750	910	16	0.5 per 600 x 600	680	277

Accessory Shelves for Rhino Cart, Twin Pack

This twin pack includes two shelves that can be used face-up or face-down, and mounted on Rhino Carts' legs.



SHF1275



SHF1212



Part No.	Dimensions (mm)	Fit Rhino Carts	Weight (kg)
SHF1275	620 x 393 x 191	1200 x 750 mm and 1500 x 750 mm	17.8
SHF1212	1111 x 398 x 191	1200 x 1200 mm	26.3

NEW PRODUCTS 2025

RHINO CART & EXPANSION OPTIONS

Rhino Cart Expansion Kit with Two Plates

Designed for versatility and efficiency, this kit allows you to seamlessly connect two 1200 x 150 mm table plates to a 1200 x 750 mm Rhino Cart to create an expansive 1200 x 1050 mm tabletop surface for your projects and tasks.

Kit includes:

- Two 1200 x 150 x 16 mm, Table Plates, nitrided (TMQ61212V-01)
- Two Connecting Blocks (TDC320)
- Two Side Beams
- Mounting Bolts

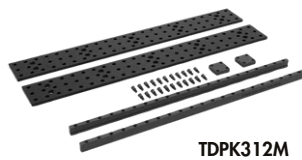

TDPK312M



Rhino Carts sold separately

Part No.	Description	Dimensions (mm)	Weight (kg)
TDPK312M	Adding 2 table plates to the Rhino Cart	1200 x 1050 x 910	56

Rhino Plate Connecting Bridge with One Plate

Designed for versatility and efficiency, this kit allows you to seamlessly connect two 1200 x 750 mm Rhino Carts or two 1200 x 1200 mm Rhino Carts.

Kit includes:

- One 1200 x 750 mm Table Plate (TDQ612075-TT)
- Two Connecting Blocks (TDC320)
- Two Side Beams
- Mounting Bolts

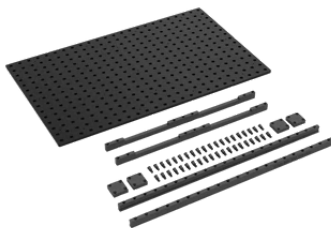

TDPK311M



Rhino Carts sold separately

Part No.	Description	Dimensions (mm)	Weight (kg)
TDPK311M	Joining two Rhino Carts 1200 x 750 mm	1200 x 2250 x 910	148
	Joining two Rhino Carts 1200 x 1200 mm	1200 x 3150 x 910	
	Joining Rhino Cart 750 x 1200 mm with 1200 x 1200 mm	1200 x 2700 x 910	

* Weight is only for Rhino Plate Connecting Bridge with One Plate (TDPK311M)

NEW PRODUCTS 2025

RHINO CART & EXPANSION OPTIONS

Rhino Cart Connecting Blocks, Twin Pack

These connecting blocks provide a solid connection when joining two Rhino Carts together. Comes with flush mount bolts that sit flush with the top side of the Rhino Cart and, and set screws to level the two Rhino Cart surfaces with each other.



TDC320

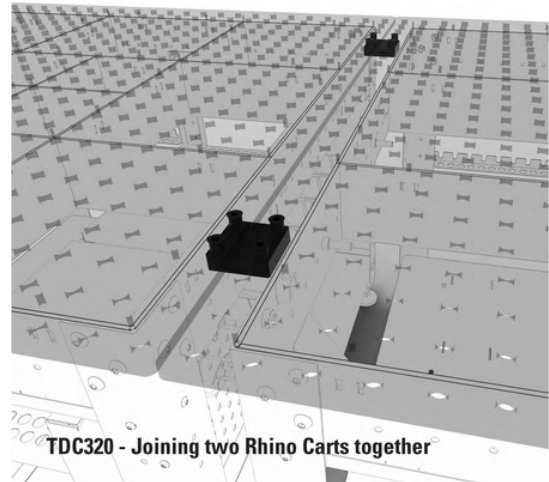

TDC320 - Joining two Rhino Carts together

Part No.	Description	Weight (kg)
TDC320	Joining two Rhino Carts together	1.7

Storage Tool Boxes for Rhino Cart

Efficiently organize and transport your tools with our Storage Tool Boxes for Rhino Cart.

These durable, high-quality boxes are specifically designed to fit onto the Rhino Cart, providing convenient storage space for all your essential tools.

Increase productivity and keep your workspace clutter-free with our Storage Tool Boxes.



Part No.	Dimensions (mm)	Fit Rhino Carts	Weight (kg)
TDB1824	450 x 610 x 520	1200 x 750 mm and 1200 x 1200 mm	33.1
TDB2224	550 x 610 x 520	1500 x 750 mm	36.5

NEW PRODUCTS 2025

RETRIEVING TOOL & SPIDER CLAMP

Magnetic Retrieving Tool

- **Powerful Lifting Capacity:** Each magnet lifts up to 29 kg, handling heavy and oversized metal sheets effortlessly.
- **Versatile Use:** Perfect for working as a pair, the MPD20 allows you to quickly and safely move large pieces of metal, even when your wingspan falls short.
- **Enhanced Safety:** Ideal for handling heated or freshly cut metal, reducing the risk of burns and injuries.
- **Compact Design:** The 2 ¾" diameter magnetic base ensures a secure grip while being easy to maneuver in tight spaces.
- **Convenience:** The switch magnet provides a reliable hold and quick release, making it perfect for fast-paced environments.
- **Durability:** Built to withstand heavy use in a fabrication shop, this tool is designed for long-lasting performance.

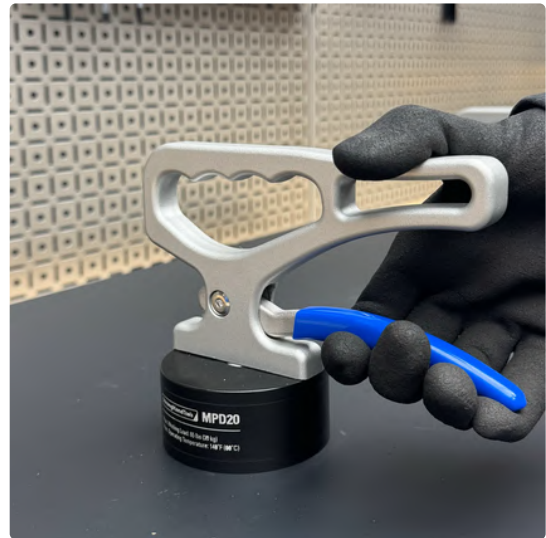

Part No.	Max. Magnetic Force (kg)	Weight (kg)
MPD20	29	0.8

"The Spider" Internal Pipe Fit-Up Clamps

Precision Alignment for Pipe Welding.

"The Spider" Internal Fit-Up Clamp ensures precise alignment for welding pipe to flange, or pipe to pipe.

- **CNC Machined for Precise Alignment:** Smooth adjustments and accurate alignment, optimal positioning for every weld.
- **Stainless Steel Contact Points:** Superior resistance to corrosion and wear.
- **Dual Locating Legs Adjustment:** Independent adjustment of the front and rear sections. Expand one set of Locating Legs to anchor securely within the pipe, while the second set of legs adjusts to perfectly align the pipe or flange.
- **Versatile Fit:** Accommodates a variety of pipe diameters from 100 to 200 mm, weighing under 10 kg, providing flexibility for various welding projects.

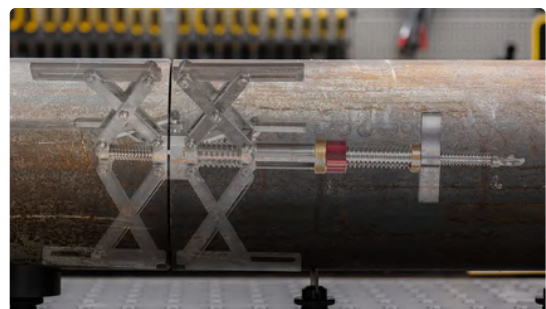

Part No.	Fit Pipes (mm)	Internal Diameter (mm)	Pipe Weight Capacity (kg)	OAL (mm)	Weight (kg)
CPF460	Ø100 ~ Ø200	Ø82 ~ Ø207	Less than 10	395	0.8

NEW PRODUCTS 2025

CLAMPS & PLIERS



Adjustable Pliers with Spring

Built with forged construction, these Water Pump Pliers have a slim profile for easy access in confined spaces.

- Forged Design
- Hardened Teeth offer a strong grip
- Return Spring provides quick jaw opening
- Phosphated Finish adds corrosion protection for long-lasting use
- Dipped Handles offer comfortable, non-slip grip for improved control during use

Part No.	Dimensions (mm)	Weight (kg)
PBX500	178 x 46 x 15	0.18

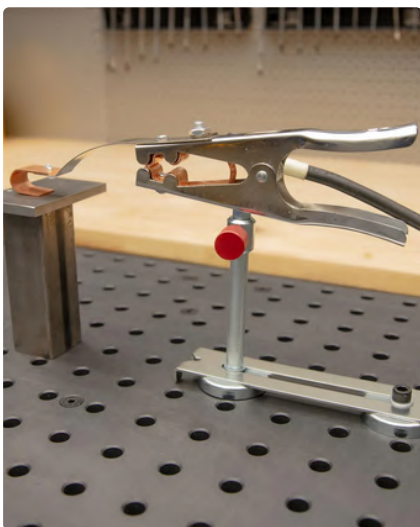

Magnetic Grounding Spring Clamp

A versatile and adjustable tool designed for efficient grounding and light clamping tasks. Featuring a unique spring clamp with a magnetic base, it offers flexibility and ease of use in a wide range of applications, from welding to electronics.

- Height Adjustable
- Magnetic Base
- Grounding Spring Clamp
- Force and Height Adjustability
- 360° Rotation
- Push Clamp Functionality
- Detachable Spring Clamp
- Copper Contact Pad

Part No.	Dimensions (mm)	Weight (kg)
MTHG200	267 x 67 x 300	1.46



"The Python" Pipe Alignment Chain Pliers

Wrap-Around Versatility for Pipe Welding

Inspired by the powerful grip of the legendary constrictor snake, "The Python" Pipe Alignment Chain Pliers provides secure and precise welding for pipes of the same diameter. Engineered to fit 24", 36", and 48" pipes, these pliers ensure accurate alignment and effortless handling.

- Stainless Steel Contact
- Versatile Fit
- Precision Alignment

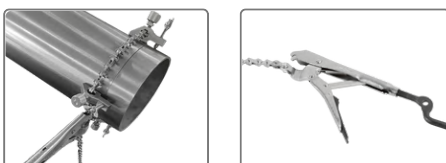

Part No.	Chain Length (mm)	Holds Pipes (mm)	Weight (kg)
PCA2048	1219.2	up to 355.6	1.8

NEW PRODUCTS 2025

LEAF SPRING CLAMPS & MAGNETIC WELDING GAUGE

Leaf Spring Clamps

The Leaf-Spring Clamp has a simple but effective design that lets you quickly clamp down on workpieces.

The clamping component functions like a leaf spring to apply force and is height and force adjustable by compressing the spring locking mechanism along the shaft; it can be rotated a full 360° and flipped upside down to act as a push clamp.

They are designed for light clamping applications and feature a v-grooved copper contact pad.



MEC100 has a magnetic V-Pad base for mounting on square or round tubing or uneven surfaces.



MEH25 features a MagTab base for mounting on square or round tubing or uneven surfaces with additional magnetic planes for mounting stock materials.

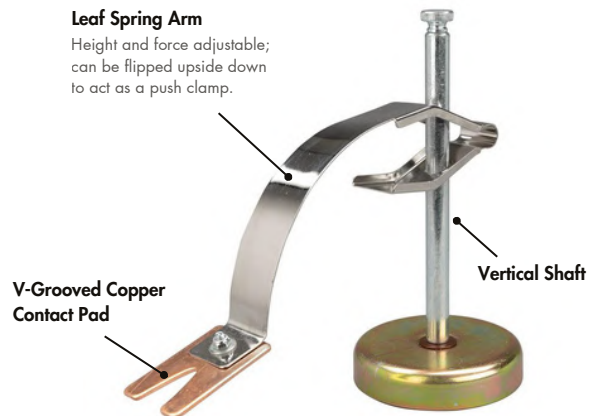

Demo Video

Model MCC90 has a magnetic base for attaching to flat metal surfaces and a vertical shaft holding the clamping arm.

Part No.	Base	Dimensions (mm)	Weight (kg)
MCC90	Magnetic Base	226 x 89 x 190	0.9
MEC100	Magnetic V-Pad w/ Anti-tipping Plate	248 x 66 x 200	0.5
MEH25	MagTab w/ Anti-tipping Plate	248 x 71 x 177	0.6

Magnetic Welding Gauge

The MVS150 is a thickness gauge featuring a magnetic V-Pad base. The feeler gauges are attached to a rotating arm providing convenience and versatile positioning. The rotating arm makes it easy for positioning adjustments. Opposite of the V-pad is a suction cup for mounting to smooth surfaces.

Measure gaps from 1/64" to 1/4", gauge sets are 4x 1/64", 2x 1/32", and 1/16".

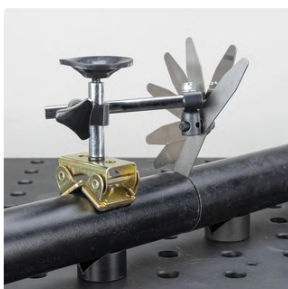

Demo Video

Magnetic V-Pad with Rubber Pads prevent scratching the surface

Part No.	Dimensions (mm)	Weight (kg)
MVS150	171 x 144 x 63	0.5

NEW PRODUCTS 2025

MAGNETIC SWITCHES & SPRING PUSH PINS

Magnetic Switch

- **59 kg / 75 kg / 107 kg Hold Force:** Strong magnetic grip for secure fixturing and lifting
- **On/Off Switch:** Mechanically switches the magnetic field on and off for easy use
- **Easy to Clean:** Simple to maintain with a wipeable surface
- **Secure Mounting:** Includes screw holes for extra security when mounted in fixtures
- **No Electrical Power Required:** Operates solely through magnetic force, no power source needed



MSJ150

Part No.	Max. Pull Force (kg)	Dimensions (mm)	Weight (kg)
MSJ150	60 kg	67 x 44 x 54	0.27
MSJ235	98 kg	90 x 60 x 72.9	0.55
MSQ165	68 kg	48 x 31 x 63.6	0.41

Spring Push Pin, For Tables with 16 mm or 28 mm Holes

Pop-In Precision and Stability for Welding Fabrication Tables

Ensure precise, stable positioning of your workpieces with the Spring Push Pins. Designed for use with welding fabrication tables, these push pins provide the right amount of force and tension to help keep your workpieces securely in place.

- **Low-Pressure Mechanism**
- **Durable Construction**
- **Easy to Use**

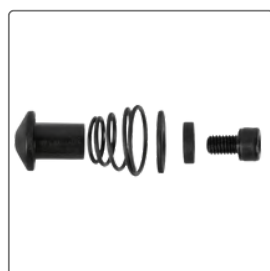

TPX520

TPX550

Part No.	Length (mm)	Diameter (mm)	Weight (kg)
TPX520	43.6	16	0.08
TPX550	56	28	0.07

NEW PRODUCTS

CATALOG 2024

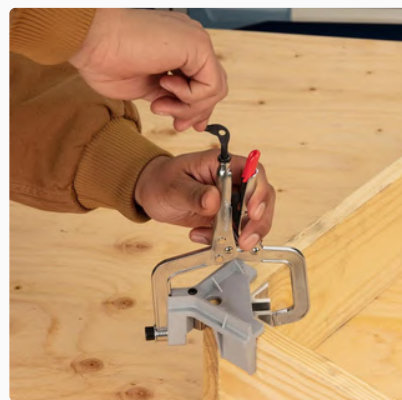

**BOLD NEW CONCEPTS TO HELP YOU WORK
COMFORTABLY & PRODUCTIVELY.**

**Strong
Hand
Europe**

www.stronghand.eu

NEW PRODUCTS 2024

E-LIFT TURNTABLE

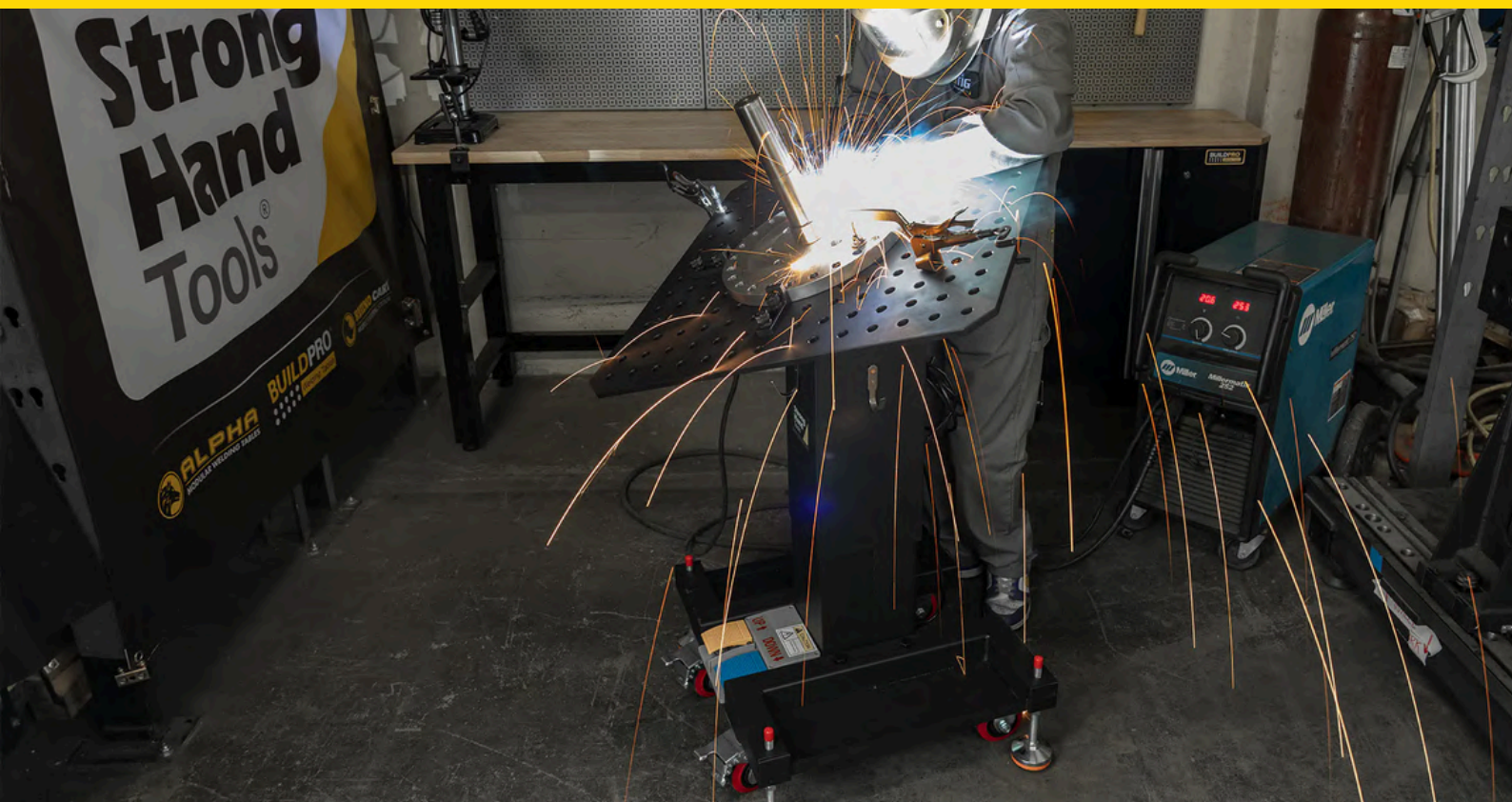

E-Lift Turntable

The electric hydraulic-powered lift is equipped with lifting capabilities and boasts a 750 x 750 mm tabletop that can rotate a full 360° and tilt up to 45°, providing unparalleled flexibility for your welding and fixturing needs.



Demo Video

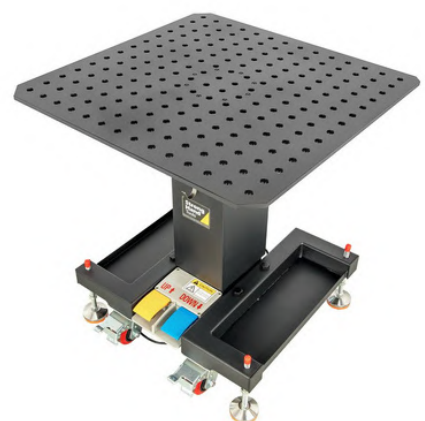

Part No.	Tabletop Dimensions (mm)	Tabletop Thickness (mm)	Hole Diameter (mm)	Grid Pattern (mm)	Height Adjustment (mm)	Load Capacity (kg)	Weight (kg)
TLA67070	750 x 750	12	16	50 x 50	800 - 1,150	300	200

NEW PRODUCTS 2024

RHINO SCISSOR LIFT & TOOL TRAY

Rhino Scissor Lift

Manual-hydraulic power, delivers lifting capabilities with a 1200 x 750 mm fixed tabletop, crafted from a high-quality nitride-coated steel plate, identical to the original Rhino Cart.

Effortlessly raise or lower the platform using the foot pedal, allowing you to achieve the perfect working height for your welding projects. This flexibility ensures optimal comfort and efficiency during your welding operations.



Demo Video

Part No.	Tabletop Dimensions (mm)	Tabletop Thickness (mm)	Hole Diameter (mm)	Grid Pattern (mm)	Height Adjustment (mm)	Static Load Capacity (kg)	Weight (kg)
TDSL12075	1200 x 750	16	16	50 x 50	548 - 970	499	200

NOMAD Tool Tray

Upgrade your welding workspace with the Tool Tray for Nomad table.

Crafted from durable galvanized steel, this tray attaches seamlessly to your Nomad table's edge, providing easy access to your pliers, welding torches, screwdrivers, and more.

Stay organized and efficient while maintaining a sleek, professional setup. Upgrade your welding experience today!

Part No.	Dimensions (mm)	Weight (kg)
TS3020-12	495 x 149 x 48	2.2

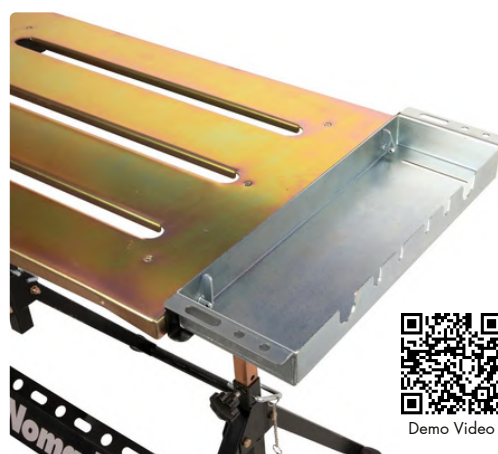

Demo Video

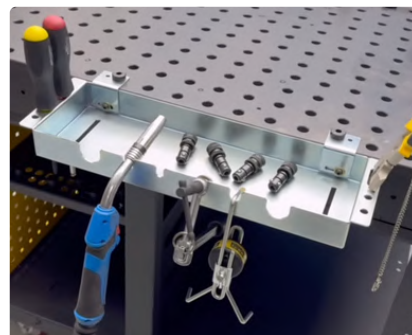
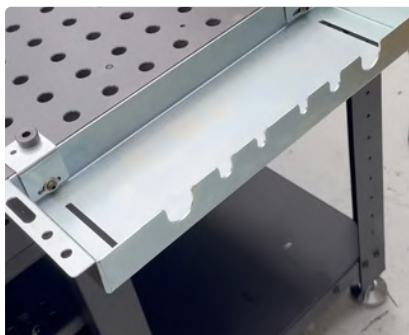
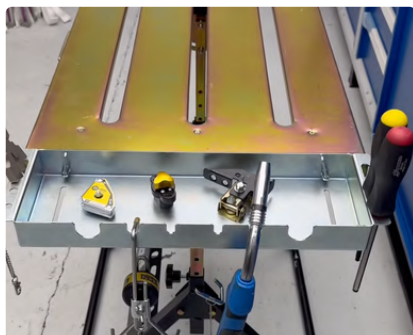

NEW PRODUCTS 2024

ESSENTIAL EQUIPMENT FOR PRECISE MARKING



Round Contour Marker

Mark accurate straight lines on pipes and curved surfaces with the Round Contour Marker, a unique tool designed to simplify your line-marking tasks and deliver impeccable results every time. Whether you're a professional tradesperson or a DIY enthusiast, this tool will become an essential part of your marking toolkit.

- Magnet Base with On/Off Switch
- Integrated Leveling Dial
- Adjustable Marking Line Angle
- Versatile Contour Marking
- Durable Construction
- User-Friendly Design



Demo Video

Part No.	Case Dimensions (mm)	Weight (kg)
RCM100	343 x 279 x 127	3.0



Round Hole Marker

Crafted from premium anodized aluminum, the Round Hole Marker is the ultimate tool for accurate and effortless hole marking.

- Switchable On/Off Magnet
- Adjustable Extension Arm
- Versatile Angle Adjustment
- Elliptical Markings
- Durable Anodized Aluminum



Demo Video

Part No.	Case Dimensions (mm)	Weight (kg)
RHM200	432 x 368 x 107	5.1



Demo Video

Magnetic Pipe Centering Head

The Magnetic Pipe Centering Head is the perfect tool for marking **pipes above 50 mm in diameter**. Designed to precisely mark center points both on the interior and exterior of pipes.

Crafted from high-quality anodized aluminum, the adjustable dial bubble protractor takes accuracy to a new level. Graduated in 2.5° increments, it ensures precise measurements.

The 360° rotatable degree dial boasts an integrated vial, guaranteeing level accuracy. Additionally, integrated magnets allow this tool to effortlessly secure itself at any desired angle on steel pipes.

Part No.	Dimensions (mm)	Weight (kg)
MPCH250	112 x 152 x 36	0.35

NEW PRODUCT 2024

GAS FLOW METER & MAGNETIC PART PICKER

Gas Flow Meter

Your essential tool for precise gas flow control in shielding gas applications like MIG and TIG welding.

- Pinpoint Accuracy: Ensure precise gas flow measurement for superior weld quality and less waste.
- Easy Compatibility: Designed for argon and carbon dioxide use, perfect for MIG and TIG welding.
- User-Friendly: Intuitive interface for effortless setup and monitoring, suitable for all skill levels.
- Built to Last: Durable construction to withstand industrial environments, ensuring reliability.

Part No.	Dimensions (mm)	Weight (kg)
GFM103	76 x 57 x 133	0.05



Demo Video

ON/OFF Magnetic Part Picker

The Magnetic Part Picker – your reliable partner in efficient part retrieval. Whether you're a professional, a DIY enthusiast, or anyone who works with small metal components, this tool is designed to simplify your tasks and enhance your overall experience.

- Powerful Switchable Magnet
- Extended Reach
- Robust Lifting Capacity
- Pivoting Head
- Premium Build



Part No.	Dimensions (mm)	Weight (kg)
MPD40	1016 x 190 x 76	1.4



Demo Video

NEW PRODUCTS 2024

WOODWORKING CLAMPS & MULTI-PURPOSE PLIERS

PLW634

Designed for 90° angle joints of equal stock and features a swivel stop for a quick and easy way of switching the direction of butt joints.

It has a max capacity of 25 mm stock and is ideal for woodworking applications.

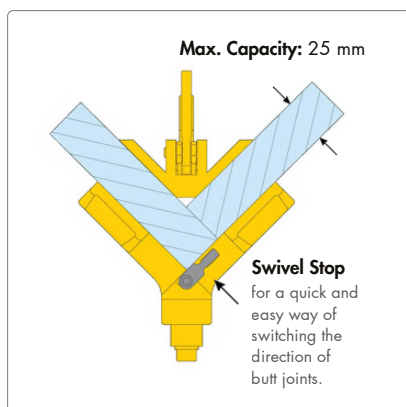

Part No.	A (mm)	B (mm)	L (mm)	Weight (kg)
PLW634	25	76	200	0.6



MULTI-PURPOSE PLIERS

One swivel pad spindle and a fixed head spindle for flexible clamping. Model **PG636** has two threaded jaw holes allow addition of accessories.

Part No.	A (mm)	B (mm)	L (mm)	Thread	Weight (kg)
PG634	100	76	216	M8	0.5
PG636	150	76	216	M8	0.5
PG114	100	89	280	M10	0.9

NEW MODEL ►

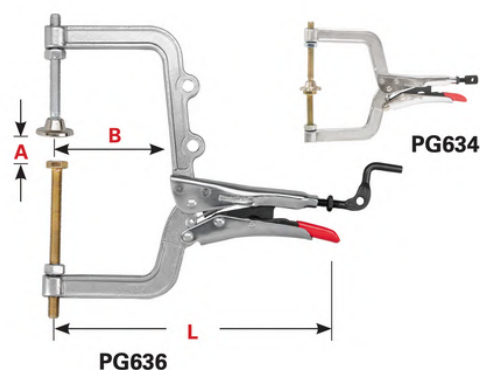

NEW PRODUCTS 2024

MAGHOLD EXTENDABLE ARM & BIG PIPE GRASSHOPPER

The MagHold, Extendable Arm 2.0

Position and hold steel stock in welding and fabrication.

Telescoping mounting bar adjusts from 200 mm to 280 mm in length. Loosen the center joint in the mounting bar to "fold up" the MagHold for different workholding configurations.

Additionally, the MagHold 2.0 features two integrated handles that let you pull the magnets off of your workspace with ease.



Part No.	Max. Pull Force (kg)	Break-away Force (kg)	Weight (kg)
MDP200	18 (ea.)	2.7 (ea.)	1.1

Big Pipe Grasshopper

The top choice when grounding large pipes for welding!

Designed with features that streamline your entire process and guaranteed to electrically ground your pipes effectively.

Easy to use, this tool keeps everything in place and ensures a solid ground connection.

- **Spring-loaded Ground Arm/Probe:** The arm swiftly grounds pipes during welding and easily swings out of the way, granting you unobstructed access for seamless welding or other equipment manipulation.
- **Dual Strong Magnets:** Equipped with swivel pads to ensure unparalleled adaptability, accommodating various pipe diameters. The strong magnets guarantee a secure and stable connection during welding.
- **All-copper grounding pad and contact probe:** Consistent and solid electrical ground throughout your welding tasks.
- **Open Cable Loop:** Designed to keep the grounding cables out of your way.



Part No.	Amperage	Max. Overall Length (mm)	Width (mm)	Max. Height (mm)	Weight (kg)
GMP500	500 A	342	76	133	1.5

NEW PRODUCTS 2024

TIG FEEDERS & TIG TUNGSTEN STICK-OUT GAUGE

TIG Feeders

Smoothly feed TIG wire for total control and accuracy, at the ideal distance, for higher quality welding, even with gloves on! Minimize filler wire waste.

- Compact, lightweight Feeder rests securely, comfortably in your hand.
- Easily customizable to set wire tension and control.
- Reduce fatigue to help prevent carpal tunnel syndrome.
- Stainless Steel.

ATF200 comes with a magnetic base and a thermal shield.

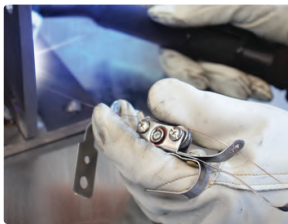

Lightweight Feeder rests securely, comfortably in your hand.



Compact Magnetic Base and Thermal Shield on Model ATF200.



Center groove on knurled thumb wheel prevents wire shift.

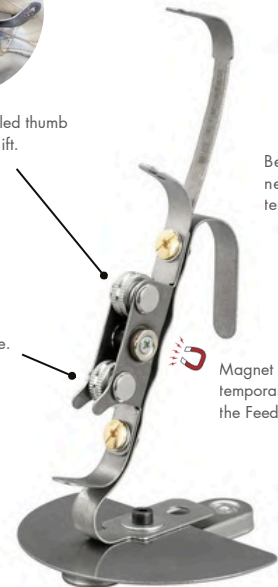

Knurled thumb wheel for positive advancement of wire.

Bend the Feeder Arm as needed to create wire tension and stability.

Magnet for vertical, temporary resting of the Feeder.

Part No.	Dimensions (mm)	Weight (kg)
ATF100	178 x 76 x 25	0.06
ATF200	178 x 89 x 89	0.14

NEW MODEL ►

TIG Tungsten Stick-Out Gauge w/ Magnetic Base

Enhance your welding precision and efficiency with the Tungsten Pro-Gauge, Round. Made from durable aluminum, this compact device is your indispensable companion for achieving consistent and accurate tungsten rod protrusion distances tailored to diverse welding applications and specifications.

- Rotating Dial for round model and Gauge Grid for square model
- Ease of Use
- Durable Aluminum Construction
- Enhanced Weld Quality
- Time and Cost Savings



Demo Video

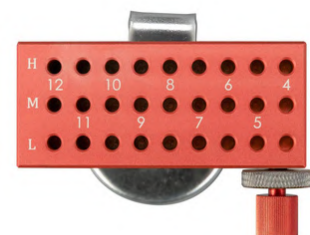

Part No.	Type	Dimensions (mm)	Weight (kg)
ATG127	Round	76 x 76 x 76	0.3
ATG227	Square	89 x 76 x 76	0.3

NEW PRODUCTS 2024

MAGNETIC TAB HOLDER

MagTab™

A better, faster way to magnetically hold tabs in place.

- **New 2.0 (MET11 and MNT15):** Available with more magnets that are now fully replaceable and provide 3X more magnetic holding force than the original design. Allow you to quickly and easily change out weak or damaged magnets.
- **Magnetic Holding:** Hold tabs and small metal pieces, parallel or perpendicular to your substructure.
- **V-Pads:** MagTabs feature an integrated V-Pad that allows you to magnetically attach to various types of surface shapes; flat, curved, or with varying angles.

* Remove the MagTab bracket to use the Adjustable Magnetic V-Pad for light duty holding of steel plates.

3X STRONGER, Better Accuracy

4+2 Replaceable Magnets



MET11

knurled knob that offers better grip and comfort when tightening to lock in the tab location.



Slot on the MagTab bracket for workpiece alignment.

NEW MODEL ►

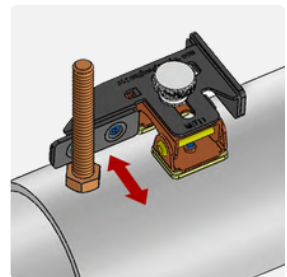
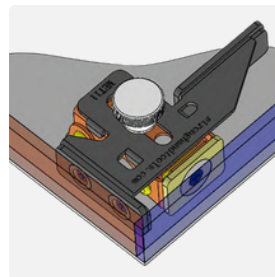

Part No.	Dimensions (mm)	Max. Pull Force (kg)	Weight (kg)
MNT15	130 x 110 x 70	35	0.4
MET11	114 x 66 x 50	20	0.2
MFT10	101 x 76 x 50	8	0.2
MDT50	71 x 55 x 44	5	0.1



POSITION, CLAMP, and FIXTURE accurately for higher quality welding and fabrication.

For the most up-to-date information on New Product Releases, please visit our website at www.stronghand.eu



Contact Us:

STRONG HAND EUROPE s.r.o.
Tomáše Bati 1075,
674 01 Třebíč,
Czech Republic

Phone: +420 607 088 465
E-Mail: asistent@stronghand.eu
Website: www.stronghand.eu

© 2025 Strong Hand Tools
All Rights Reserved.

